



TITAN[®]

SUPERIOR BOLTING SOLUTIONS[®]

TITAN HYDRAULIC TORQUE WRENCHES

T Series, LP Series & SuperThin



SUPERIOR BOLTING SOLUTIONS[®]

Manufactured and Assembled in the USA

T Series

Hydraulic Torque Wrenches



- **Calibrated**
- **Powerful**
- **Compact**
- **Accurate**
- **Durable**



- **Certified torque accuracy +/- 3%**
- **Calibration certification supplied with each tool**
- **Manufactured to ISO 9001:2008 and EN/JISQ/AS9100:2008 quality standards**



- **Faster**
- **Light-Weight**
- **Efficient**

TITAN's Patented Technology T SERIES ***The Global Standard*** for Hydraulic Torque Tools



- **Patented Housing** - Exceptional strength, resulting in longer tool life and less repair costs.
- **TITAN TruSwivel™** - Patented, multi-axis design provides a low profile combined with ease of motion.
- **Designed from Finite Element** - Advancing the art of the hydraulic wrench giving greater value and lower cost of ownership.
- **Patented Piston Dampening System** - Eliminates tool breakdown normally incurred from over-stroke and shock damage resulting in longer tool life and lower repair costs.



- **Finely Crafted** - Highest quality aircraft grade materials for unrivaled strength and durability.
- **Guaranteed Quality** - Titan's products have the strongest warranty in the business. Manufactured to ISO 9001:2008 and EN/JISQ/AS9100:2008 The highest standard in the business.
- **Unique Drive Pawl Design** -Unrivaled durability, accuracy and efficiency.
- **TITAN T SERIES - Proven!** *Titan Technologies is the fastest growing company in our industry. We provide a better engineered tool at competitive prices. Our tools are designed for longer life so your total cost of ownership is less with Titan. The quality of our products, our service, and our people are the reason for this unprecedented growth.*



Unsurpassed Accuracy & Repeatability

Every Titan Hydraulic Torque Wrench is cycle tested under load and then calibrated. All Titan tools have certification of calibration with traceability to N.I.S.T. Titan testing equipment is calibrated by NVLAP Accredited Calibration Laboratory.

ENGINEERED FOR QUALITY ... BUILT TO LAST!

FOUR times
the LIFE EXPECTANCY
of our competitors!



Titan's Patented Piston Dampening System protects the tool and the operator when loosening the most stubborn fasteners.



Fast, Dependable, Accurate. Titan T Series gets the job done even in the most hostile environment.



Patented Multi-Axis Swivel provides better accessibility and prevents hose kinking.

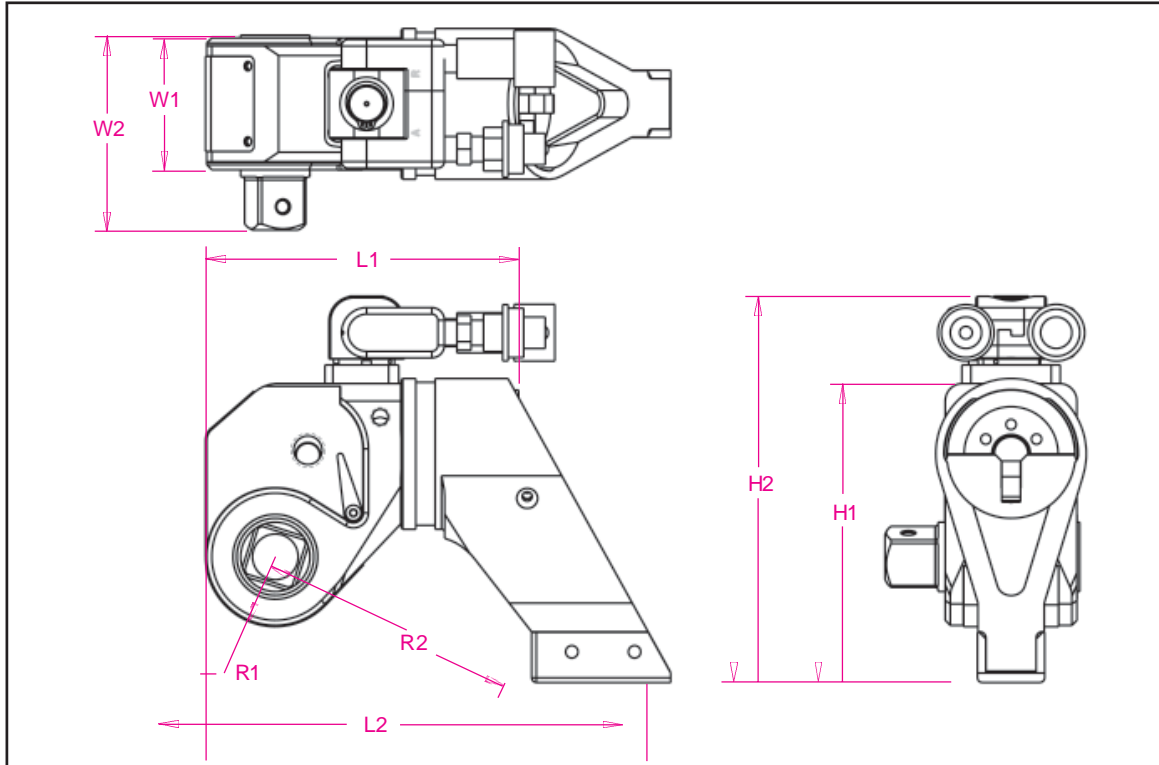

High quality impact sockets are available in fractional, metric, 12-point and castellated styles.



Titan's patented housing handles the difficult jobs with ease.

TITAN MODEL NUMBER	Units	T1	T3	T5	T8	T10	T25	T50
Square Drive Size	(In)	3/4	1	1-1/2	1-1/2	1-1/2	2-1/2	2-1/2
Optional Square Drive Sizes	(In)	1/2 & 1	3/4 & 1 1/2	1 & 2 1/2	1 & 2 1/2	1 & 2 1/2	1 1/2 & 3 1/2	3-1/2
Range Optional Hex Drive Sizes (Other sizes and special drives are available upon request)	(In)	3/8 to 1	5/8 to 1 1/4	1 to 1 1/2	1 1/8 to 1 3/4	1 1/4 to 2	1 5/8 to 2 1/4	1 5/8 to 2 3/4
	(mm)	9 to 26	16 to 32	26 to 38	28 to 45	32 to 51	41 to 57	41 to 70
Torque Range	(Ft-Lb)	197 to 1359	468 to 3124	816 to 5605	1168 to 8062	1662 to 11067	3726 to 24749	8274 to 54176
	(N-M)	267 to 1843	635 to 4236	1107 to 7601	1584 to 10932	2254 to 15007	5052 to 33560	11220 to 73463
Weight: Includes Reaction Arm	(Lb)	5.0	10.0	17.0	25.0	30.0	70.0	115.0
	(Kg)	2.27	4.54	7.71	11.34	13.61	31.75	52.15
DIMENSIONS								
L1 - Body Length	(In)	4.81	6.29	7.10	7.70	8.80	11.80	14.75
	(mm)	122.2	159.8	180.3	195.6	223.5	299.7	374.7
L2 - Overall Length: Includes Arm	(In)	6.95	9.59	11.22	12.57	13.89	18.52	21.50
	(mm)	176.5	243.6	285.0	319.3	352.8	470.4	546.1
H1 - Tool Height	(In)	3.63	4.93	5.75	6.50	7.84	9.60	15.00
	(mm)	92.2	125.2	146.1	165.1	199.1	243.8	381.0
H2 - Overall Height: Includes Swivel	(In)	4.95	6.75	7.71	8.49	9.11	11.55	16.80
	(mm)	125.7	171.5	195.8	215.6	231.4	293.4	426.7
W1 - Tool Width	(In)	1.98	2.63	3.15	3.57	3.95	5.25	7.00
	(mm)	50.3	66.8	80.0	90.7	100.3	133.4	177.8
W2 - Tool Width: Includes Sq. Drive	(In)	2.83	3.89	4.65	5.09	5.61	7.48	9.25
	(mm)	71.9	98.8	118.1	129.3	142.5	190.0	235.0
R1 - Tool Radius around the Bolt	(In)	0.98	1.13	1.56	1.76	1.95	2.60	3.00
	(mm)	24.9	28.7	39.6	44.7	49.5	66.0	76.2
R2 - Reaction Reach	(In)	3.85	5.33	6.15	6.96	7.69	11.30	12.50
	(mm)	97.8	135.4	156.2	176.8	195.3	287.0	317.5

- Powerful
- Compact
- Accurate
- Durable
- Faster
- Light-Weight
- Efficient

LP Series



- Certified torque accuracy +/- 3%
- Calibration certification supplied with each tool
- Manufactured to ISO 9001:2008 and EN/JISQ/AS9100:2008 quality standards



Extreme Low Profile, Engineered to Fit the Tightest Applications!



- **Unique Ratchet Tooth Design** - Superior durability and accuracy.
- **TITAN TruSwivel™** - Advanced, patented, multi-axis design provides a low profile combined with ease of motion.
- **Finely Crafted** - Highest quality aircraft grade materials for unrivaled strength and long life.
- **Ratcheting Assurance Mechanism** - Hands free safety and unmatched repeatability.
- **Patented Piston Dampening System** - Eliminates piston and cylinder damage due to over-stroke.



- **Sleek Design** - Easy fit on the tightest bolt patterns.
- **Unique** - "Wide Track" ratchet pawl mechanism distributes stress evenly and provides for more contact area than other designs for longer tool life and reduced repair costs.
- **Width of Link and Cylinder is Comparable** - Flat design fits more applications.
- **Aluminum-Bronze Drive Bushings** - Provides longer tool life.
- **Tight Radius Link Cassettes** - Engineered from FEA for greater strength and versatility.
- **"Set Back" Cylinder Design** - Allows the tool to fit on even the most restrictive bolt pattern.



“The Standard for Hydraulic Torque Wrenches”

Manufactured to ISO 9001:2008 and EN/JISQ/AS9100:2008 Quality Standards

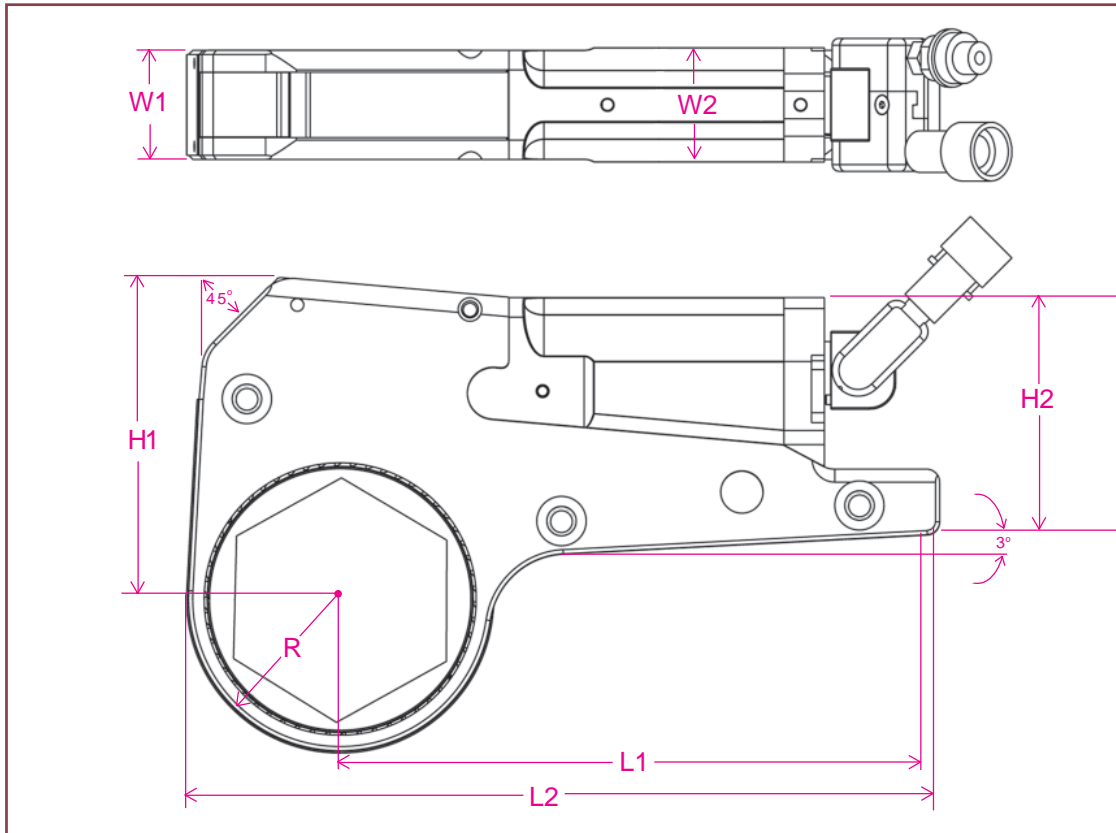

Low cost step-down sleeves are available in all sizes



Available in fractional & metric sizes, hex & 12 pt., square & 8 pt.



Patented multi-axis swivel provides for better accessibility and prevents hose kinking

TITAN MODEL NUMBER	Units	LP 2	LP 4	LP 8	LP 16	LP 32	LP 48
Range of Hex Sizes A/F	(in) (mm)	3/4 to 2-3/8 19 to 60	7/8 to 3-1/8 22 to 80	1-1/4 to 4-1/2 32 to 115	1-5/8 to 4 5/8 41 to 120	2-3/16 to 6-1/8 56 to 155	3-1/8 to 6-1/8 80 to 155
Torque Range	(ft-lb) (n-m)	268 to 1826 363 to 2476	568 to 3788 770 to 5137	1075 to 8024 1457 to 10881	2400 to 16000 3201 to 22009	5250 to 35000 7119 to 47460	7125 to 38000 9662 to 51528
Cylinder Weight	(lb) (kg)	3.45 1.56	5.8 2.63	10.2 4.62	15.5 7.03	18 8.16	19.4 8.80
Range of Link Weight	(lb) (kg)	2.20 to 3.50 1.00 to 1.58	5.25 to 7.50 2.38 to 3.40	11.40 to 14.10 5.17 to 6.39	19.70 to 27.60 8.93 to 12.51	32.00 to 99.00 14.50 to 44.90	35.00 to 99.00 15.87 to 44.90
DIMENSIONS							
L1-Maximum Reaction Reach	(in) (mm)	7.00 177.80	8.41 213.69	11.31 287.32	14.00 355.60	16.00 406.40	16.00 406.40
L2-Overall Length	(in) (mm)	8.90 226.06	10.70 271.78	14.27 362.59	17.95 455.93	19.25 488.95	19.25 488.95
H1-Center of Bolt to Top of Tool	(in) (mm)	3.86 98.17	4.77 121.29	6.16 156.67	7.25 184.15	10.50 266.70	10.50 266.70
H2-Back End Height	(in) (mm)	3.45 87.63	3.78 96.14	6.05 153.67	8.50 215.9	10.90 276.86	11.40 289.56
W1-Tool Width at Link	(in) (mm)	1.25 31.75	1.62 41.28	2.10 53.34	2.35 59.69	2.55 64.77	2.55 64.77
W2-Tool Width at Cylinder	(in) (mm)	1.25 31.75	1.75 44.45	2.10 53.34	2.45 62.23	2.80 71.12	3.10 78.74
R-Tool Radius around Bolt	(in) (mm)	1.03 to 1.75 26.16 to 44.48	1.31 to 2.30 33.32 to 58.47	1.72 to 2.95 43.82 to 74.98	1.95 to 3.50 49.53 to 88.9	2.50 to 4.75 63.5 to 120.65	2.75 to 4.75 70.0 to 120.65



Fast, Dependable, Accurate. TITAN LP Series shown here tightening bolts on Wimbledon roof



Tool lies flat for better accessibility

Titan LP Series Tools are manufactured solely from aircraft grade, high strength alloys selected for their superior stress and fatigue resistant properties.

TITAN®

LP SuperThin™ Series Links

Specialty EXTREME LOW PROFILE Hydraulic Wrenches



LP Series Standard Link and SuperThin™ Link

Designed and developed for those very tight applications such as BOP bolting and other hard to access applications. The Titan SuperThin™ Series Links are made to deliver an accurate and repeatable torque in even the tightest applications. The tools are continuous ratcheting and eliminate the heretofore time consuming and inaccurate methods. Patent-pending design uses a concentric strap instead of side plates to provide unsurpassed performance, strength and accuracy.

A continuous ratcheting tool. All tools are provided with certification of calibration to +/- 3% torque system accuracy.

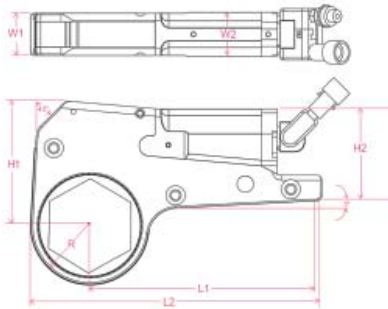

TITAN MODEL NUMBER	Units	LP 2	LP 4
Range of Hex Sizes A/F	(in) (mm)	3/4 to 2-3/8 19 to 60	7/8 to 3-1/8 22 to 80
Torque Range	(ft-lb) (n-m)	190 to 1900 270 to 2700	390 to 3900 560 to 5600
Cylinder Weight	(lb) (kg)	3.45 1.56	5.8 2.63
Range of Link Weight	(lb) (kg)	1.00 to 3.00 0.45 to 1.36	4.50 to 6.50 2.01 to 2.90
DIMENSIONS of Titan SuperThin™ Extreme access Links			
L1-Maximum Reaction Reach	(in) (mm)	7.00 177.80	8.41 213.69
L2-Overall Length	(in) (mm)	8.90 226.06	10.70 271.78
H1-Center of Bolt to Top of Tool	(in) (mm)	3.86 98.17	4.77 121.29
H2-Back End Height	(in) (mm)	3.45 87.63	3.78 96.14
W1-Tool Width at Link	(in) (mm)	.75 19.00	1.00 25.40
W2-Tool Width at Cylinder	(in) (mm)	1.25 31.75	1.75 44.45
R-Tool Radius around Bolt	(in) (mm)	1.00 to 1.70 26.16 to 44.48	1.25 to 2.25 33.32 to 58.47

TITAN®

PLUS SERIES PUMPS WITH FAN COOLED HEAT EXCHANGER

**Decreases operational heat by up to 25%!
Extends pump life!
Reduces overheating downtime!**



Titan offers heat exchangers for both its EXE Series and Plus Series Hydraulic Wrench pumps. The heat exchangers can be fitted to preowned Titan pumps or can be purchased installed on your new pump. Designed for heavy use applications such as plant shutdowns, outage turn around and wind power. The Titan heat exchangers help extend the life of the pump and prevent downtime caused by pump overheating.

Part Number	Description
TITAN E115-FC	Titan 115v/60hz, High Speed Torque Wrench Pump. Single Tool Port w/ Fan Cooled Heat Exchanger
TITAN E230-FC	Titan 230v/50hz, High Speed Torque Wrench Pump. Single Tool Port w/ Fan Cooled Heat Exchanger
TITAN E115-4FC	Titan 115v/60hz, High Speed Torque Wrench Pump, 4-Tool Ports w/ Fan Cooled Heat Exchanger
TITAN E230-4FC	Titan 230v/50hz, High Speed Torque Wrench Pump. 4-Tool Ports w/ Fan Cooled Heat Exchanger
TITAN TWIN ELECTRIC-FC	Titan DUAL MOTOR PUMP w/ Extreme High Flow Hydraulic Wrench Applications (1500 cu. in. per min) 230v/50hz, Single Tool Port w/ Fan Cooled Heat Exchanger
E115FC E230FC	Upgrade kit for existing pumps. We can upgrade several pump versions, including older models. Call or e-mail for complete details. Upgrades are not field installable.

Heat Exchangers are standard on all Titan EXE MAX Express Series Models

TITAN[®] Twin[™] Hydraulic Wrench Pumps
Standard Features Include:

- 2 Powerful Motors
- LIGHT ALLOY Housing & Tank
- Integral Carrying Handle
- Internal Low Pressure Regulator
- Valve Configuration: 4-Way Spool Solenoid
- Filter-Lubricator-Regulator

- Easy Access Oil Fill Port
- Oil Sight Gauge with Thermometer
- 2 Gallon / 7.6 Liter Oil Reservoir
- 10,000 psi / 700bar 15' / 4.5m Hydraulic Hose Assy
- Safety Hose Burst Guards
- 20' / 6.1 Meter Remote Control Assy

- Heavy Duty "Dead Man" Safety Switch
- External Adjustable Pressure Regulator
- Retract Side Internal Relief Valve
- Maximum Pressure: 10,000 psi (700 bar)
- Precision Liquid Filled Dual Scale Gauge
- Single or 4-Tool Manifold

<i>Twin-Plus Air</i>	Model Number	Maximum Oil Flow vs Pressure	Length	Width	Height	Weight
	<i>Model P+ TWIN Single Port</i>	1340 cu. in./min @ 100 psi (22 liter/min @ 7 bar)	19" 282mm	16.5" 840mm	19.8" 503mm	116 lb 52kg
	<i>Model P+4 TWIN Four Port</i>	1340 cu. in./min @ 100 psi (22 liter/min @ 7 bar)	19" 282mm	16.5" 840mm	19.8" 503mm	116 lb 52kg

Power Requirements: 70-100psi / 95 cfm air • Flow: 1340 cu. in. / 22 lpm per min

<i>Twin-Plus Electric</i>	Model Number	Maximum Oil Flow vs Pressure	Length	Width	Height	Weight
	<i>E230 Twin 230V Single Port</i>	1440 cu. in./min @ 100 psi (23.6 liter/min @ 7 bar)	19" 282mm	16.5" 840mm	19.8" 503mm	116 lb 52kg
	<i>E230 Twin-4 230V 4 Port</i>	1440 cu. in./min @ 100 psi (23.6 liter/min @ 7 bar)	19" 282mm	16.5" 840mm	19.8" 503mm	116 lb 52kg

Power Requirements: 220v-50hz / 26 amp • Flow: 1440 cu. in. / 23.6 lpm per min

TITAN[®] WindMaster[™]
Electric/Hydraulic
Torque Wrench Pumps

Designed for Wind Power. Desired by industry wherever portability, durability and superior performance is preferred.



46% Smaller than
Conventional Torque Wrench Pumps

- Sturdy steel constructed protective frame
- Integral safety rated certified lifting hook
- 4-port manifold for multiple tool usage
- Exceptional gauge protection
- Quick disconnect remote control
- Extremely flat design
- Low center of gravity
- Industrial oil filter (built-in tank)
- Standard with rubber feet
- Automatic heat exchanger for oil temperature control
- Post operational cooling fan for optimum performance

- Weight 56 lbs (25.4 kg)
- Brushless .75 hp (.56kw) Motor
- 1 Gallon (4 Liter) Reservoir

	Performance	Oil Flow	Dimensions
TITAN[®] WindMaster[™] 230	0-1100 psi 1100-3200 psi 3200-10000 psi	390 cu. in/min 110 cu. in/min 43 cu. in/min	Length: 16.2 in Width: 11.8 in Height: 17.5 in
TITAN[®] WindMaster[™] 115	0-1100 psi 1100-3200 psi 3200-10000 psi	390 cu. in/min 110 cu. in/min 43 cu. in/min	Length: 16.2 in Width: 11.8 in Height: 17.5 in

Standard Features on TITAN® Express Pumps Include:

Fan Cooled Heat Exchangers are Standard on Titan EXE Series Full Frame Electric Pumps

- 3 Stage Piston Design (faster at working pressures)
- 4-Way Valve
- Maximum Pressure 10,000 psi (700 bar)
- Easy Access Pressure Setting
- Quiet - Meets OSHA Standards
- Max Pumps Have Single or 4-Tool Ports
- Mini Pumps Have 1-Tool Port
- Heavy Duty 25 ft. (7.62 m.) Remote
- Liquid Filled Pressure Gauge psi/bar
- 15 ft. (4.57 m.) Hose Pair



	Performance	Oil Flow	Dimensions	Weight	Reservoir	Power
EXPRESS MAX	0-1100 psi 1100-3200 psi 3200-10000 psi	390 cu. in/min 110 cu. in/min 43 cu. in/min	Length: 16.2 in Width: 11.8 in Height: 17.5 in	59 lbs	2 Gal.	.75 hp
Part Number EXE-MAX	0-76 bar 76-220 bar 220-700 bar	6.4 liter/min 1.8 liter/min 0.7 liter/min	Length: 41 cm Width: 30 cm Height: 44 cm	27 kg	7.57 L.	.56 kw
EXPRESS MINI	0-1100 psi 1100-3200 psi 3200-10000 psi	235 cu. in/min 66 cu. in/min 25 cu. in/min	Length: 12.6 in Width: 8.7 in Height: 17.0 in	31 lbs	1 Gal.	.35 hp
Part Number EXE-MINI	0-76 bar 76-220 bar 220-700 bar	3.9 liter/min 1.1 liter/min 0.4 liter/min	Length: 32 cm Width: 22 cm Height: 43 cm	14 kg	3.78 L.	.26 kw
EXPRESS Whirlwind Auto Cycle	0-1100 psi 1100-3200 psi 3200-10000 psi	520 cu. in/min 180 cu. in/min 80 cu. in/min	Length: 17.0 in Width: 10.0 in Height: 19.5 in	72 lbs	2 Gal.	1.5 hp
Part Number EXE-HP-AUTO	0-76 bar 76-220 bar 220-700 bar	8.5 liter/min 2.9 liter/min 1.3 liter/min	Length: 40 cm Width: 38 cm Height: 46 cm	33 kg	7.57 L.	1.12 kw
EXPRESS Auto Cycle	0-1100 psi 1100-3200 psi 3200-10000 psi	390 cu. in/min 110 cu. in/min 43 cu. in/min	Length: 16.2 in Width: 11.8 in Height: 17.5 in	63 lbs	2 Gal.	.75 hp
Part Number EXE-MAX-AUTO	0-76 bar 76-220 bar 220-700 bar	6.4 liter/min 1.8 liter/min 0.7 liter/min	Length: 41 cm Width: 30 cm Height: 44 cm	28 kg	7.57 L.	.56 kw
EXPRESS Max Air	0-1100 psi 1100-3200 psi 3200-10000 psi	460 cu. in/min 153 cu. in/min 55 cu. in/min	Length: 20.5 in Width: 13.8 in Height: 20 in	66 lbs	2 Gal.	3.75 hp
Part Number EXA-MAX	0-76 bar 76-220 bar 220-700 bar	7.5 liter/min 2.5 liter/min 0.9 liter/min	Length: 52 cm Width: 35 cm Height: 51 cm	30 kg	7.57 L.	2.80 kw
EXPRESS Mini Air	0-1100 psi 1100-3200 psi 3200-10000 psi	275 cu. in/min 86 cu. in/min 32 cu. in/min	Length: 12.2 in Width: 11.5 in Height: 16.5 in	41 lbs	1 Gal.	1.50 hp
Part Number EXA-MINI	0-76 bar 76-220 bar 220-700 bar	4.5 liter/min 1.4 liter/min 0.5 liter/min	Length: 31 cm Width: 29 cm Height: 42 cm	19 kg	3.78 L.	1.12 kw

TITAN® Plus Series Pumps

Standard Features on TITAN® Express Pumps

- LIGHT ALLOY Housing & Tank
- Integral Carrying Handle
- Internal Low Pressure Regulator
- Configuration: 4-Way Spool Valve
- Filter-Lubricator-Regulator
- Easy Access Oil Fill Port
- Oil Sight Gauge with Thermometer
- 2 Gallon / 7.6 Liter Oil Reservoir
- 10,000 psi / 700bar 15' / 4.5m Hydraulic Hose Assy
- Safety Hose Burst Guards
- 20' / 6.1 Meter Remote Control Assy
- Heavy Duty "Dead Man" Safety Switch
- External Adjustable Pressure Regulator
- Retract Side Internal Relief Valve
- Maximum Pressure: 10,000 psi (700 bar)
- Precision Liquid Filled Dual Scale Gauge
- Single or 4-Tool Manifold
- Twin Pump Available

TITAN® Plus Series Air

Power Requirements: 70-100psi / 50 cfm air • Flow: 670 cu in / 11.1 lpm per min. • Powerful 3 HP motor (2.24Kw)



Model Number	Maximum Oil Flow vs Pressure	Length	Width	Height	Weight
<i>Model P+ Single Port</i>	670 cu. in./min @ 100 psi (11.1 liter/min @ 7 bar)	9.5" 241mm	16.5" 419mm	19.8" 503mm	58 lb 26kg
	55 cu. in./min @ 10000 psi (1 liter/min @ 700 bar)				
<i>Model P+4 Four Port</i>	670 cu. in./min @ 100 psi (11.1 liter/min @ 7 bar)	9.5" 241mm	16.5" 419mm	19.8" 503mm	58 lb 26kg
	55 cu. in./min @ 10000 psi (1 liter/min @ 700 bar)				

TITAN® Plus Series Electric With Optional Heat Exchanger

Power Requirements: 115v-60hz/ 25 amp • Flow: 720 cu. in. / 11.8 lpm per min • 1 1/8 hp motor (.9kw)



Model Number	Maximum Oil Flow vs Pressure	Length	Width	Height	Weight
<i>E115 Single Port</i>	720 cu. in./min @ 100 psi (11.8 liter/min @ 7 bar)	9.5" 241mm	17.1" 434mm	8.1" 460mm	46 lb 20.8kg
	56 cu. in./min @ 10000 psi (.91 liter/min @ 700 bar)				
<i>E115-4 4-Port</i>	720 cu. in./min @ 100 psi (11.8 liter/min @ 7 bar)	9.5" 241mm	17.1" 434mm	8.1" 460mm	46 lb 20.8kg
	56 cu. in./min @ 10000 psi (.91 liter/min @ 700 bar)				

Power Requirements: 220v-50hz / 13 amp • Flow: 720 cu. in. / 11.8 lpm per min • 1 1/8 hp motor (.9 kw)



Model Number	Maximum Oil Flow vs Pressure	Length	Width	Height	Weight
<i>E220 Single Port</i>	720 cu. in./min @ 100 psi (11.8 liter/min @ 7 bar)	9.5" 241mm	17.1" 434mm	8.1" 460mm	46 lb 20.8kg
	56 cu. in./min @ 10000 psi (.91 liter/min @ 700 bar)				
<i>E220-4 4-Port</i>	720 cu. in./min @ 100 psi (11.8 liter/min @ 7 bar)	9.5" 241mm	17.1" 434mm	8.1" 460mm	46 lb 20.8kg
	56 cu. in./min @ 10000 psi (.91 liter/min @ 700 bar)				



SUPERIOR BOLTING SOLUTIONS®

Titan offers an extensive selection of 700 bar (10,000 psi) pressure gauges for hydraulic wrench usage.



Model 080055:
Precision Liquid Filled Gauge
Model 090228-14:
1/4% Accuracy w/Certificate
Model 090058:
1/2% Accuracy w/Certificate



FLR Filter Lubricator Regulator

Titan offers both integrated and free standing FLR's

4-Tool Manifolds and Protective Cages



Quick Connects, Couplers, Fittings



Accessories for the T Series Tool

THE PERFECT ACCESSORY FOR YOUR JOB TO USE WITH YOUR T TOOL

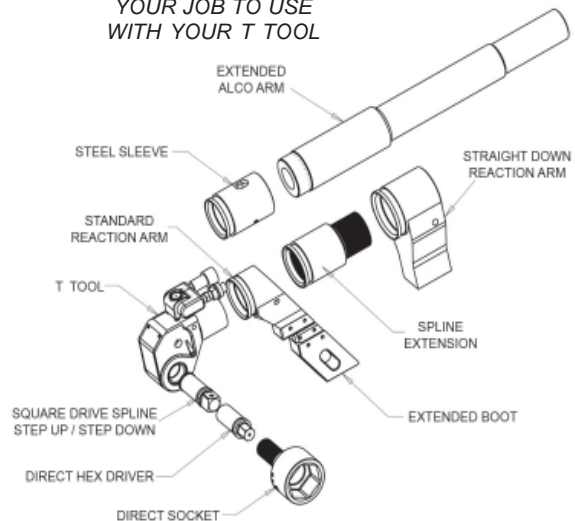

- Extended, Short and Special Reaction Arms
- Square Drives
- Direct Drives and Sockets
- Impact Sockets
- Square & Hex Drive Accessories
- Hex Stock
- Calibration Services
- Hydraulic Hoses
- Maintenance & Repair Kits
- Training and Certification



Titan offers a diverse combination of accessories to be used with its Hydraulic Wrench Pumps.

They include:

- 4-tool manifolds
- Protective cages
- Sight gauges with thermometer

Torque Wrench Hoses Twin Line Hose Quick Disconnect Couplers

Model: 090172 = 15 ft length
Model: 090173 = 20 ft length
Model: 090174 = 25 ft length
Model: 090175 = 30 ft length
Model: 090176 = 35 ft length



Custom tooling for easy repair and maintenance of your Titan Hydraulic Wrenches are available. Shown here are o-ring installation tools which make quick work of changing the seals and an end cap removal and installation tool.



Light Alloy ALCO reaction arms are available for all Titan Hydraulic Wrench models.

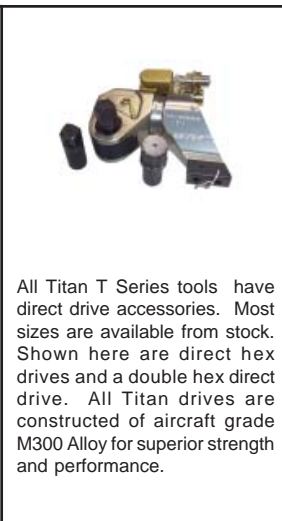

All Titan T Series tools have direct drive accessories. Most sizes are available from stock. Shown here are direct hex drives and a double hex direct drive. All Titan drives are constructed of aircraft grade M300 Alloy for superior strength and performance.



Special long reaction arms are available for all tools.



Light alloy and stubby short reactions arms are available for special applications.

Accessories for the LP & SuperThin™ Tool



THE PERFECT ACCESSORY
FOR YOUR JOB TO USE
WITH YOUR LP TOOL

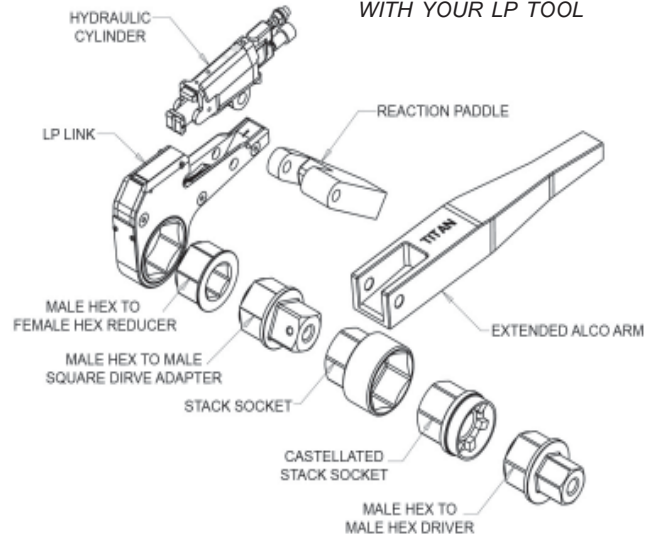

- Reaction arms including ALCO extended reaction arm
- Hex & 12 pt. step-down sleeves
- Stack sockets
- Square drive adapter
- Hex stock



Custom Cages for Hydraulic Wrench Pumps. Shown here is the customized WIND TURBINE Cage designed for optimal protection and ease of movement in WIND applications.

Customized tooling kits available

Shown are Vestas Wind Turbine and BOP "Choke & Kill" kits

TITAN® Power Spreader™
You Can Open, Spread, Lift and Level.
Easy! Fast! Quiet! Safe!

TITAN® TriHold™
Mechanical Back-Up Wrench Sets
5 pc set fits all hex nuts from 25MM (1") to 107MM (4-3/16")
Revolutionary design grips 3 flats of any hex nut, metric or fractional.
HANDS FREE • INTRINSICALLY SAFE
Fast • Strong • Compact • Versatile

TITAN Mission Statement

Our objective is to be the world's leading provider of bolting solutions by manufacturing and supplying the highest quality and most comprehensive product line of Hydraulic, Pneumatic & Electric Torque Wrenches and accessories, Hydraulic Nuts, Tensioners, and other high-end bolting technologies on the market.

We deliver a higher value to the customer through superior products, outstanding service, along with innovative engineering support and leading edge customer driven technologies.

Honesty, integrity, professionalism and an uncompromised commitment to excellence are what define us. We succeed for the benefit of our customers, shareholders, employees, dealers and representatives.

Titan Technologies - Different from other companies that sell bolting products and services. Titan is a solutions based company which features a vast array of solutions to any bolting application.



People: Titan enjoys a worldwide network of experienced experts trained to recommend the most cost-effective solution for your bolting application.

Technical Expertise - Titan has bolting applications experience in multiple industries including power generation, wind, oil & gas, ship building & repair, refining, chemicals, pulp and paper and more.



Quality: Our products are manufactured using the latest aerospace finite element design techniques and machined to the tightest tolerances in the business, to ISO 9001:2008 and EN/JISQ/AS9100:2008 quality standards.

Local Service - Extensive network of independent sales representatives and authorized dealers located worldwide.



Engineering: Patently different. Titan spends a higher percentage of its revenue in research and development to ensure the highest quality and most durable products on the market.

Quality Guarantee
Comprehensive Extended Warranty

ADDITIONAL PRODUCTS & SERVICES OFFERED

- Titan ETite™ Electric Torque Wrenches
- Titan Bolt Tensioners - Modular Style
- Titan Bolt Tensioners - Dedicated Style
- Titan Hydraulic Nuts
- Titan Power Flange Spreaders
- Titan Power Nut Splitters
- Titan AirTite® Pneumatic Torque Wrenches
- Sockets & Accessories
- Striking Wrenches
- Rentals
- Equipment Service & Repair
- Calibration Services



9001 Jameel Street, Suite 180 Houston, TX 77040
Email sales@titanti.com www.titanti.com

Toll-Free + 1.866.345.8484

Phone + 1.281.449.9994

Fax + 1.281.449.9996

BR_HY_08-15-2010

